AM***NN1*EH**

:

SAMSUNG

Operating temperature and humidity • Pairing an indoor unit with a remote control

Cleaning the indoor unit exterior • Cleaning the outdoor unit heat exchanger •
Cleaning the air filter • Periodical maintenance • Troubleshooting



prevent possible harm to the environment or human health from uncontrolled waste disposal, please separate these

Household users should contact either the retailer where they purchased this product, or their local government office, for details of where and how they can take these items for environmentally safe recycling.

For information on Samsung's environmental commitments and product-specific regulatory obligations, e.g. REACH, WEEE, Batteries, visit : samsung.com/uk/aboutsamsung/samsungelectronics/corporatecitizenship/data_corner.html

to ensure that you know how to safely and efficiently operate the extensive
Because the following operating instructions cover various models, the
this manual. If you have any questions, call your nearest contact centre or find



Hazards or unsafe practices that may result in severe personal injury or death.



Hazards or unsafe practices that may result in minor personal injury or property



Make sure the machine is grounded to prevent electric shock.



-
-
- If the voltage/frequency/rated current condition is different, it may cause



-

-

-



-

-



-

- Never plug the power cord into a socket that is not grounded correctly



- Failing to do so may result in abnormal vibrations, noise, or problems with
 - Failing to do so may result in water overflowing and property damage. Avoid adding drain to waste pipes as odours may arise in the future.
-



- may overflow and result in property damage.



-



-



-

-
-



- Do not use a ventilating fan.
 -
 -
 - A delivery service for the product is not provided. If you reinstall the
 -
- in the air, please contact your nearest service centre.



- -
 -
 - If a child places a bag over its head, it may result in suffocation.
 -
 - Take special care that children do not injure themselves by inserting their
-



- Take special care that children do not injure themselves by inserting their

-

- This may result in children seriously injuring themselves.

-



-



-

-



-

-



-

-

-

-

-

-

-



-

-







- To avoid cutting your fingers, wear thick cotton gloves when cleaning it.
- This should be done by a qualified technician please contact your installer or service centre.



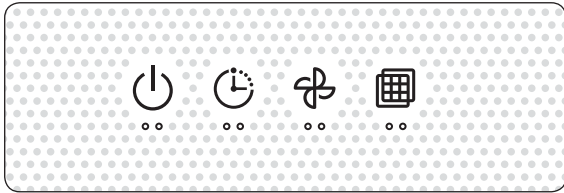
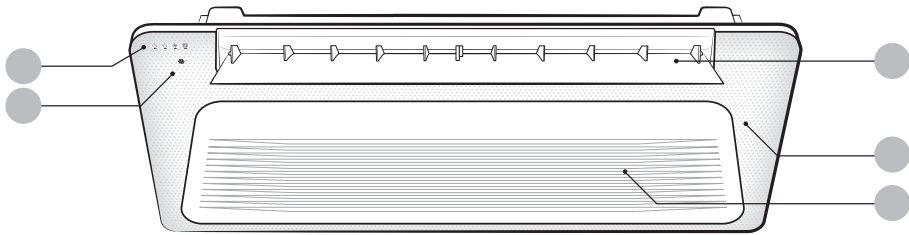



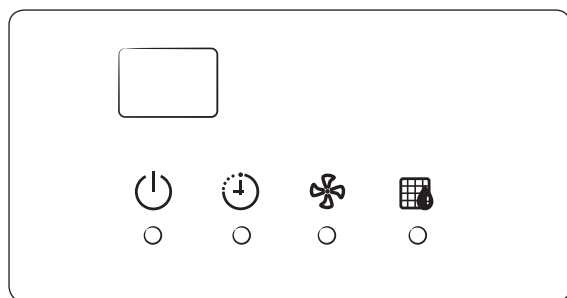
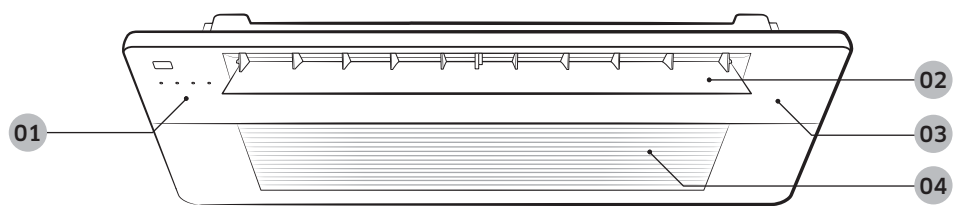

- For cleaning inside the appliance, contact your nearest service centre.
 -
 -
 - Make sure to prevent any injury from sharp edges of the surface when
-

PC1×WFMAN



	<ul style="list-style-type: none">• Heating and cooling model:• Cooling only model: Operation
	
	
	



	
	<ul style="list-style-type: none">• Heating and cooling model:• Cooling only model: Operation
	
	
	



- If you use the air conditioner at a relative humidity above 80%, it may cause a formation of
-
- If the indoor unit is out of the operating temperature and humidity range, the safety device may

When using multiple indoor unit, you can control individually pairing remote control and indoor unit.



- , have to push 
- Each indoor unit number setting must be set by the installer when installing. Contact service

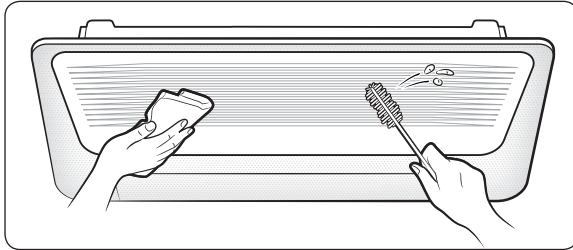

Remove the dust accumulated in the narrow



- acid, hydrochloric acid, or organic solvents
-
-

local service center for help.

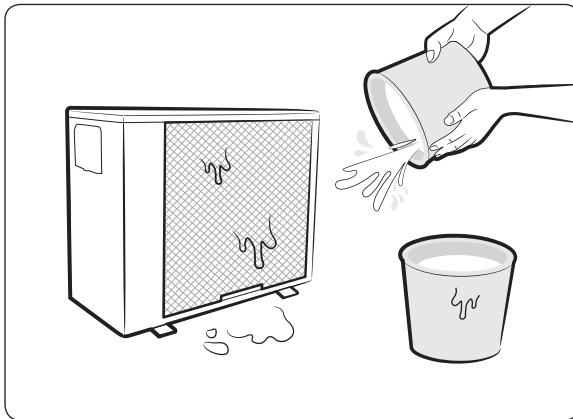

-
-
- of the outdoor unit, contact the local service



- Be sure to hold the grille with a hand to prevent dropping from the opening of the front grille.



- When removing the grill completely, unhook the safety hooks on both sides of the grill.

PC1XWFMAN / PC1NUSMAN

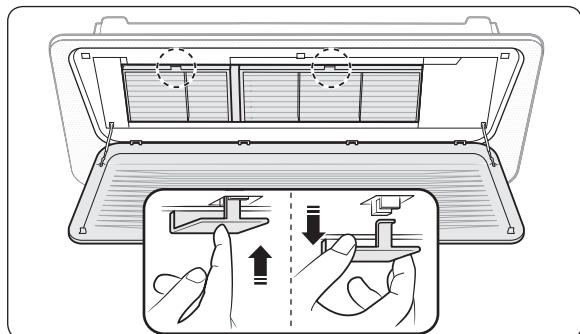
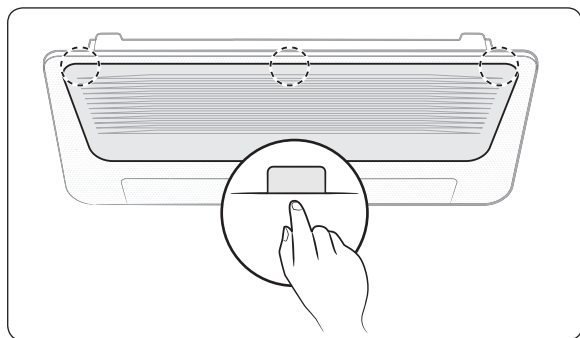

Press the Push signs (▽) on the air filter.

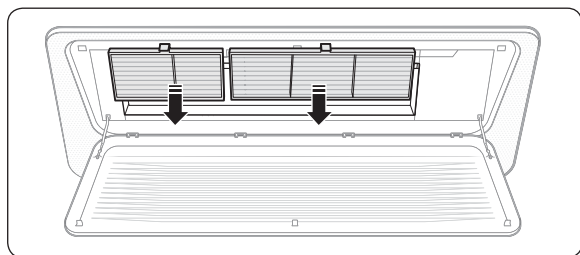

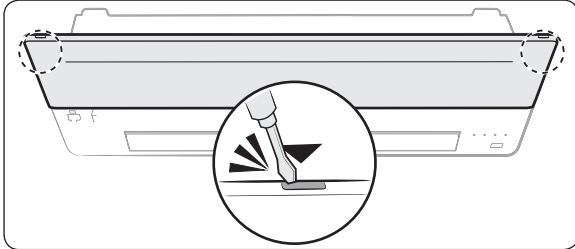

Insert a driver at the marked points and open

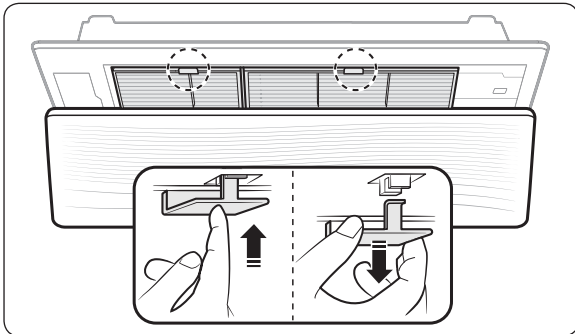
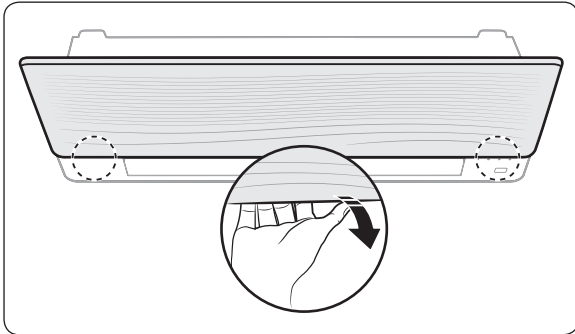
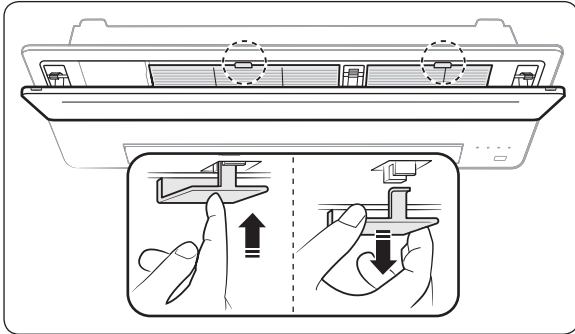

•

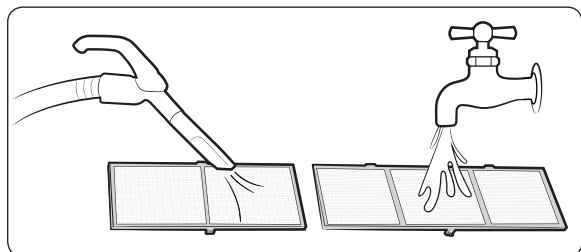

Clean the air filter with a vacuum cleaner or soft brush. If dust is too heavy, then rinse it with running water and dry it in a ventilated area.



-

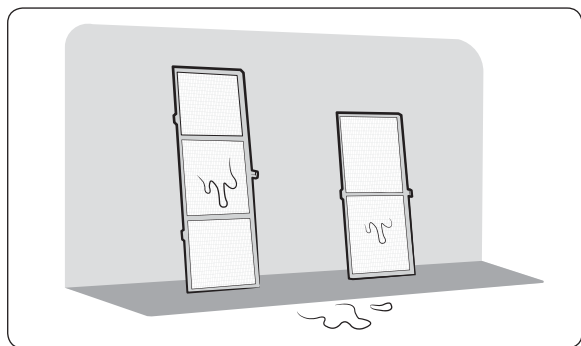

-

produce offensive odours. Clean it again and dry it in a well-ventilated area.

-

on the usage and environmental conditions, so clean the air filter every week if the air

- You can request a filter cleaning service. Note that it is a charged service.

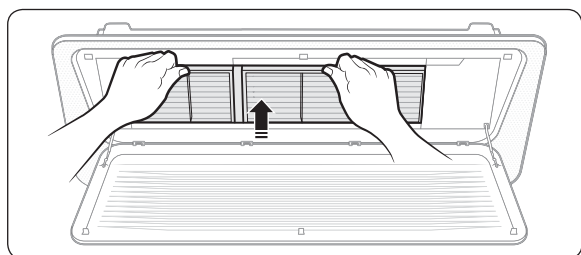

To assemble the air filter, proceed in reverse



-

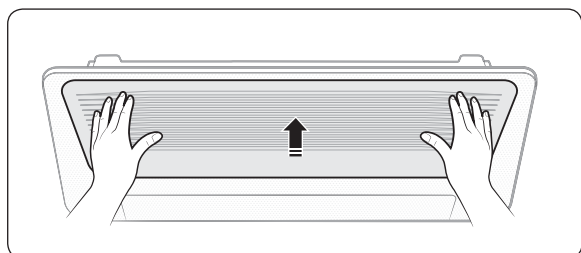

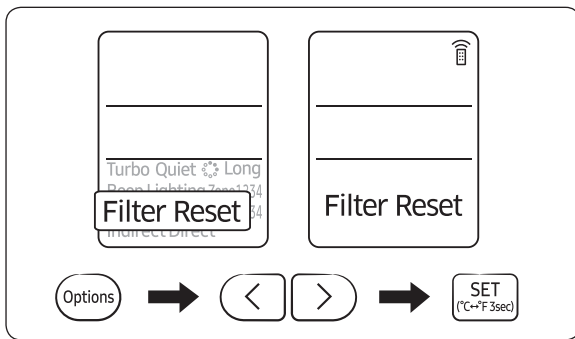
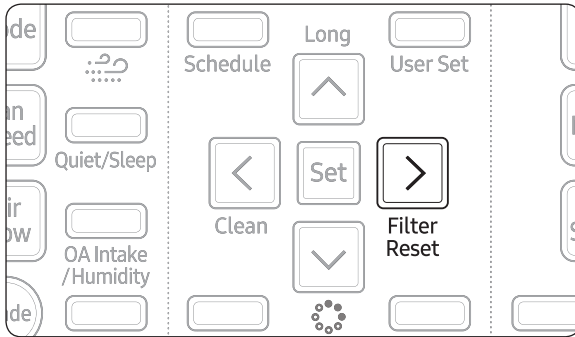

follows:



- Indoor unit with the wired remote control:
- Indoor unit with the wireless remote control:
button → < or > → () Blinking → press the



- every time you clean the air filter although



			Required
			Required
		Once every 4 months	Required
		Once every 4 months	Required
			Required
			Required
			Required
			Required
			Required
			Required

	<ul style="list-style-type: none">•  the auxiliary power switch, and then contact a service centre.
	<ul style="list-style-type: none">• turned on or off sequentially. This operation takes up to 32 seconds.
	<ul style="list-style-type: none">• 
	<ul style="list-style-type: none">• • If the indoor unit display is still blinking, contact a service centre.
	<ul style="list-style-type: none">• Operate the air conditioner with a electric fan to save energy and
	<ul style="list-style-type: none">• Remote control: Press the Temperature button repeatedly until the set temperature (minimum: 18°C) is set to lower than the current• Remote control: Press the Temperature button repeatedly until the set temperature (maximum: 30°C) is set to higher than the current• frequently.• If a cover is on the outdoor unit or any obstacle is present near the outdoor unit, remove them.• Install the outdoor unit in a well-ventilated place. Avoiding places• Place a sunscreen over the outdoor unit to protect it from direct sunlight.•

	<ul style="list-style-type: none">• Close the windows and doors to maximize the cooling and heating•• immediately to prevent cool air from coming out at the beginning.• may be decreased. Avoid exceeding the maximum pipe length.
	<ul style="list-style-type: none">•• 
	<ul style="list-style-type: none">• entering from outside, ventilate the room properly.••• Fan mode for 3 to 4 hours to dry the inside of the indoor unit for removal•
	<ul style="list-style-type: none">•
	<ul style="list-style-type: none">•
	<ul style="list-style-type: none">• Condensation may develop due to the difference in temperature. This is
	<ul style="list-style-type: none">•



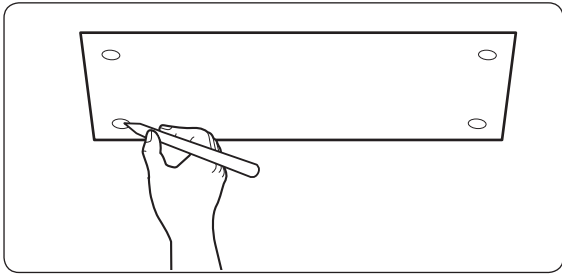

•

•

•



•

•



•

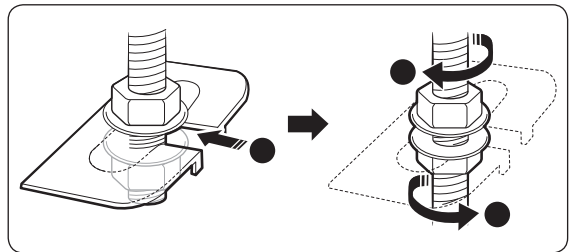
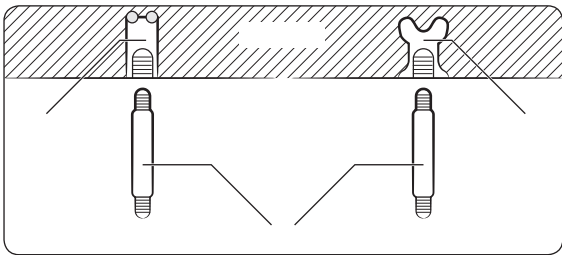

•

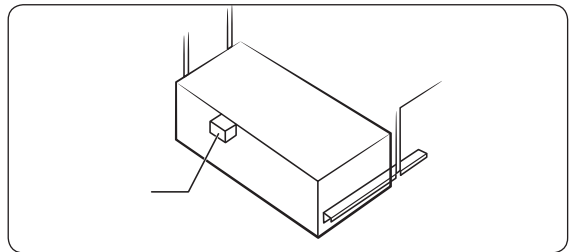
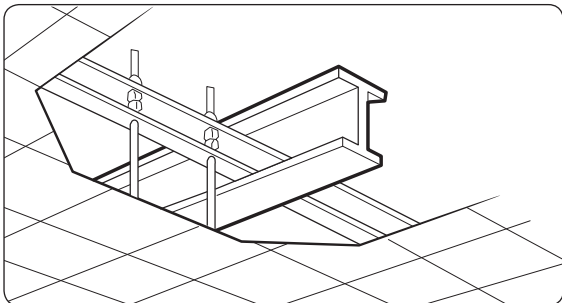

-
-
-
-

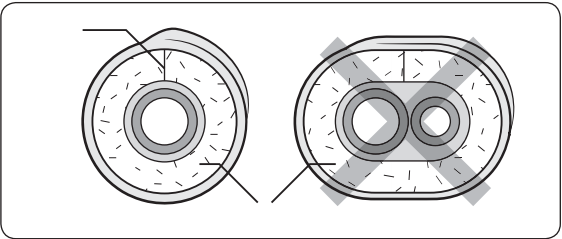
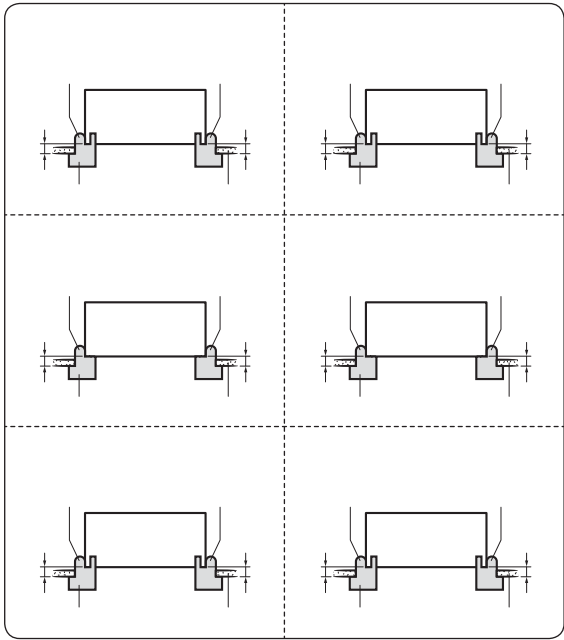
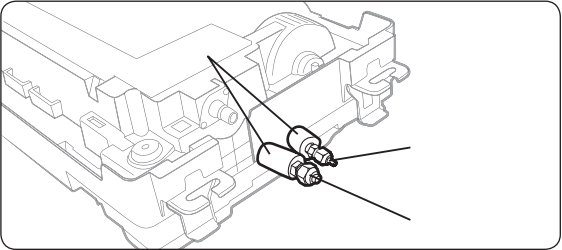

-

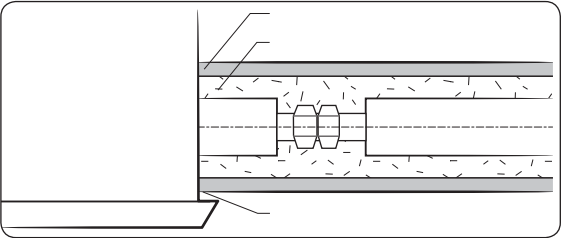



-
-

-
-

-

-

-

-

-

-

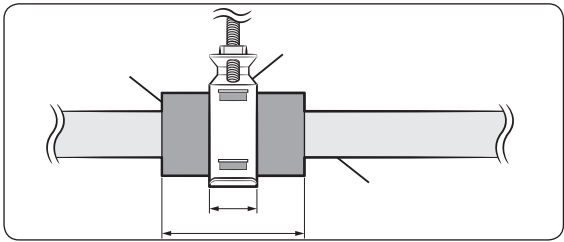

			←	
			←	

•

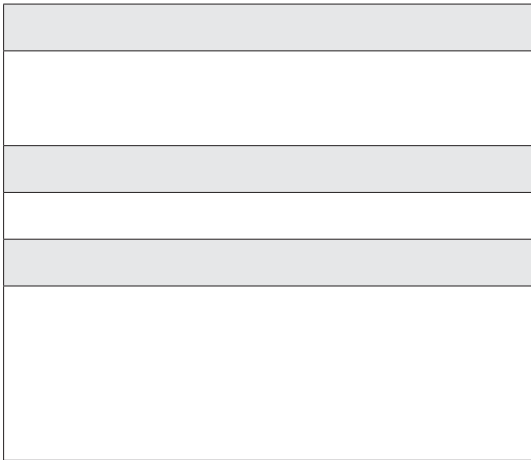

•

-
-
-
-
-

•

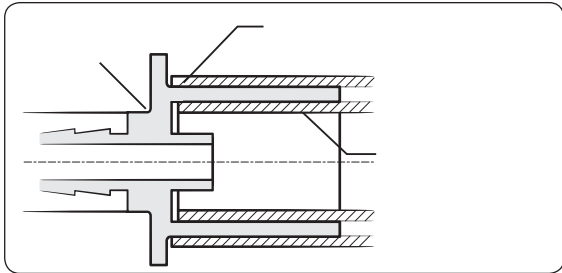

•

•

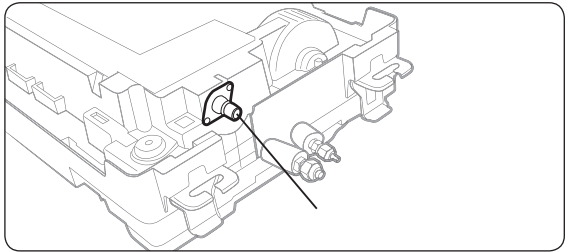

•

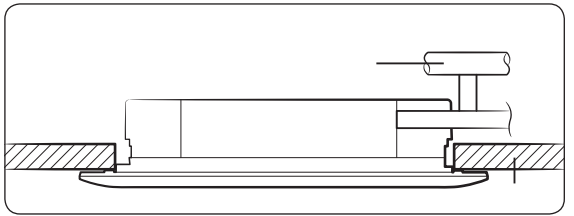

•

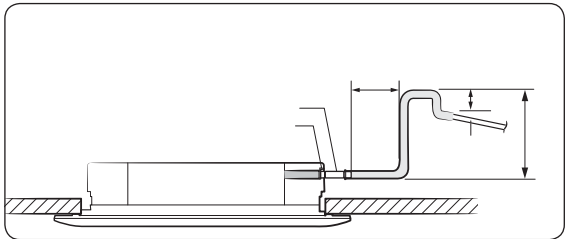

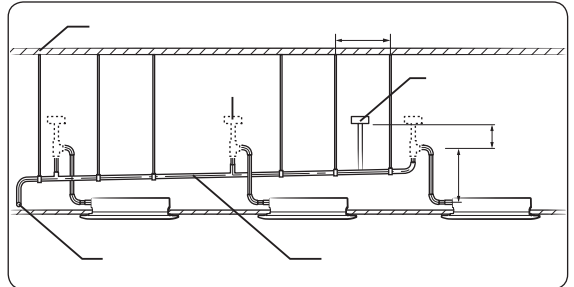
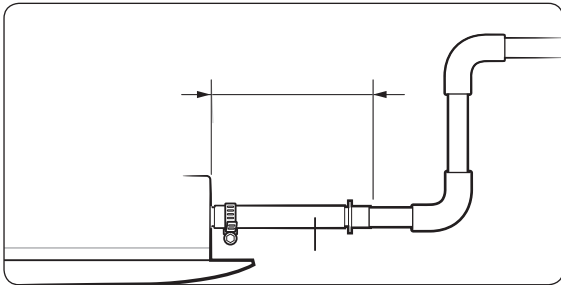
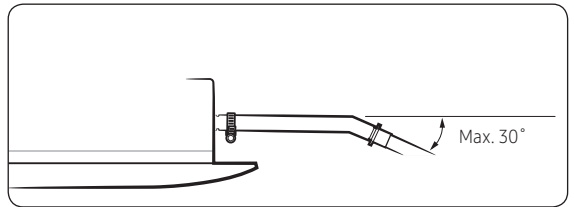
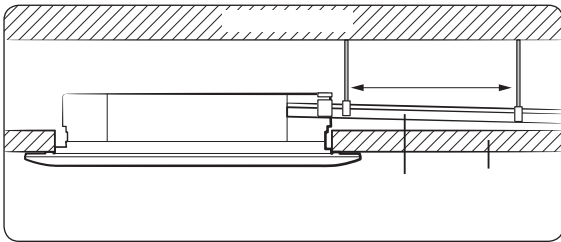
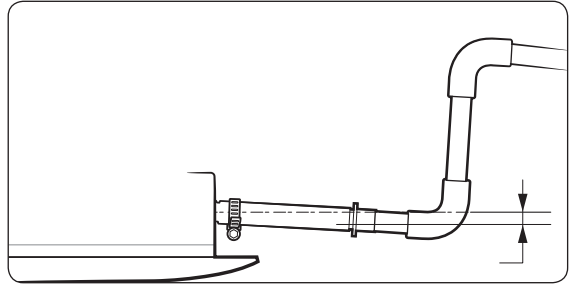
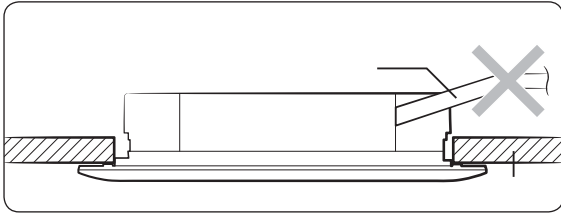

-
-

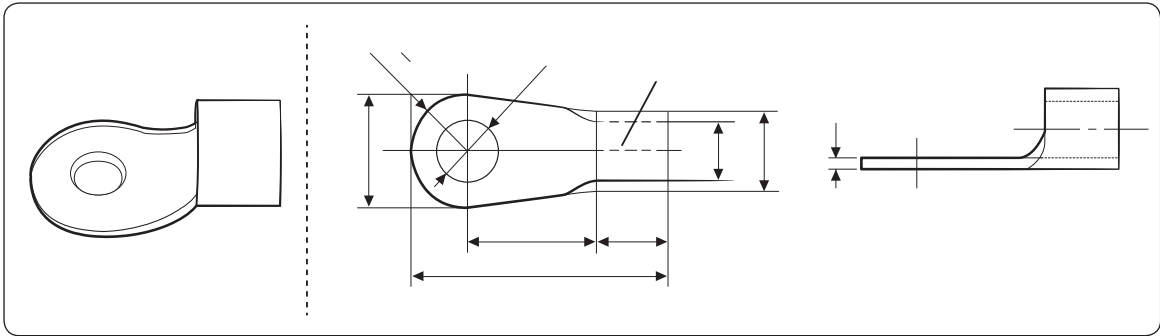



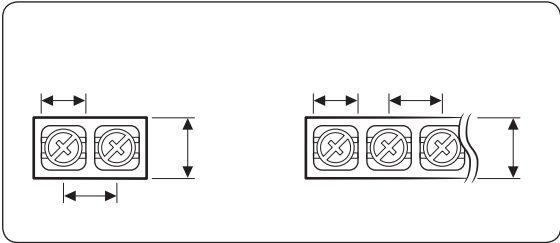

AM017NN1PEH✕	
AM022NN1PEH✕	
AM022NN1DEH✕	
AM028NN1DEH✕	
AM036NN1DEH✕	
AM056NN1DEH✕	
AM071NN1DEH✕	

Σ (_____)

The capacity of ELB, MCCB X[A] = 1.25 X 1.1 X ΣAi



-
- ΣAi : Sum of rating currents of each indoor unit.



-
-
-

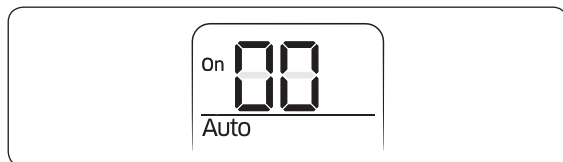
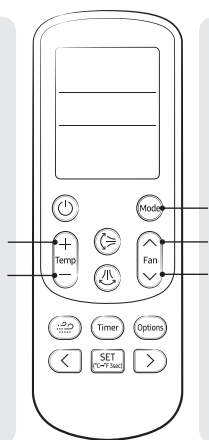

-
-
-

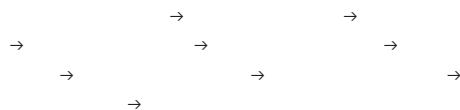

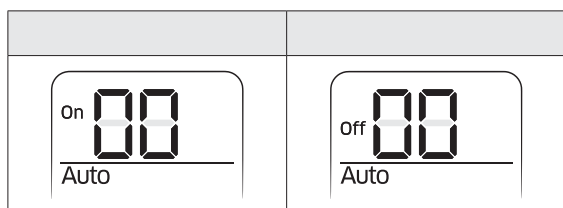

<div><div>Fan</div><div>Fan</div><div>Fan</div><div>Fan</div><div>0 → 1 → ... E → F</div></div>	<div>On 00 Auto</div> <div>On 88 Auto</div>
<div>Mode</div>	<div>On 00 Cool</div>
<div><div>Fan</div><div>Fan</div><div>Fan</div><div>Fan</div><div>0 → 1 → ... E → F</div></div>	<div>On 00 Cool</div> <div>On 88 Cool</div>
<div>Mode</div>	<div>On 00 Dry</div>
<div><div>Fan</div></div>	<div>On 00 Dry</div>

<div>Fan</div> <div><div>Fan</div><div>0 → 1 → ... E → F</div><div>Fan</div></div>	<div>On 80</div> <div>Dry</div>
<div>Mode</div>	<div>On 00</div> <div>Fan</div>
<div>Fan</div> <div><div>Fan</div><div>0 → 1 → ... E → F</div><div>Fan</div></div>	<div>On 88</div> <div>Fan</div> <div>On 80</div> <div>Fan</div>
<div>Mode</div>	<div>On 00</div> <div>Heat</div>
<div>Fan</div> <div><div>Fan</div><div>0 → 1 → ... E → F</div><div>Fan</div></div>	<div>On 88</div> <div>Heat</div> <div>On 80</div> <div>Heat</div>

	<div><div>Off</div><div>00</div><div>Auto</div></div>
<div><div><div>Fan</div><div>↓</div></div><div><div>Fan</div><div>↑</div></div><div><div>Fan</div><div>↓</div></div><div><div>Fan</div><div>↑</div></div><div>0 → 1 → ... E → F</div></div>	<div><div>Off</div><div>00</div><div>Auto</div></div> <div><div>Off</div><div>88</div><div>Auto</div></div>
	<div><div>Off</div><div>00</div><div>Cool</div></div>
<div><div><div>Fan</div><div>↓</div></div><div><div>Fan</div><div>↑</div></div><div><div>Fan</div><div>↓</div></div><div><div>Fan</div><div>↑</div></div><div>0 → 1 → ... E → F</div></div>	<div><div>Off</div><div>00</div><div>Cool</div></div> <div><div>Off</div><div>88</div><div>Cool</div></div>
	<div><div>Off</div><div>00</div><div>Dry</div></div>
<div><div><div>Fan</div><div>↓</div></div></div>	<div><div>Off</div><div>00</div><div>Dry</div></div>

<div><div>Fan</div><div><div>Fan</div><div>Fan</div><div>0 → 1 → ... E → F</div></div></div>	<div><div>off 80</div><div>Dry</div></div>
<div><div>Mode</div></div>	<div><div>off 00</div><div>Fan</div></div>
<div><div>Fan</div><div><div>Fan</div><div>Fan</div><div>0 → 1 → ... E → F</div></div></div>	<div><div>off 00</div><div>Fan</div></div> <div><div>off 80</div><div>Fan</div></div>
<div><div>Mode</div></div>	<div><div>off 00</div><div>Heat</div></div>
<div><div>Fan</div><div><div>Fan</div><div>Fan</div><div>0 → 1 → ... E → F</div></div></div>	<div><div>off 00</div><div>Heat</div></div> <div><div>off 80</div><div>Heat</div></div>

-
-
-
-
-
-
-
-

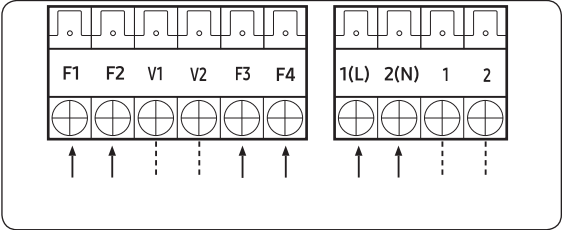

✕ The output of hot coil terminal is AC 220 V / 230 V

[illegible]

[illegible]

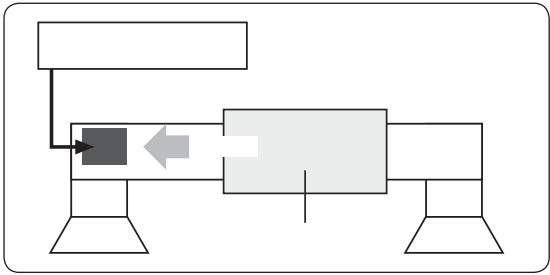

.

					→
	→				

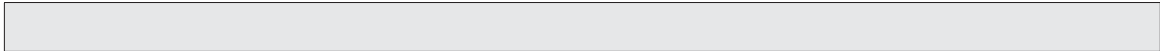

						Heating → Cooling
		change Cooling →				



[illegible]

Example 2) Setting 02 series SEG15 ="2" / Setting 05 series SEG18 ="A": Room temp. \leq set temp. + f (heating

-

-

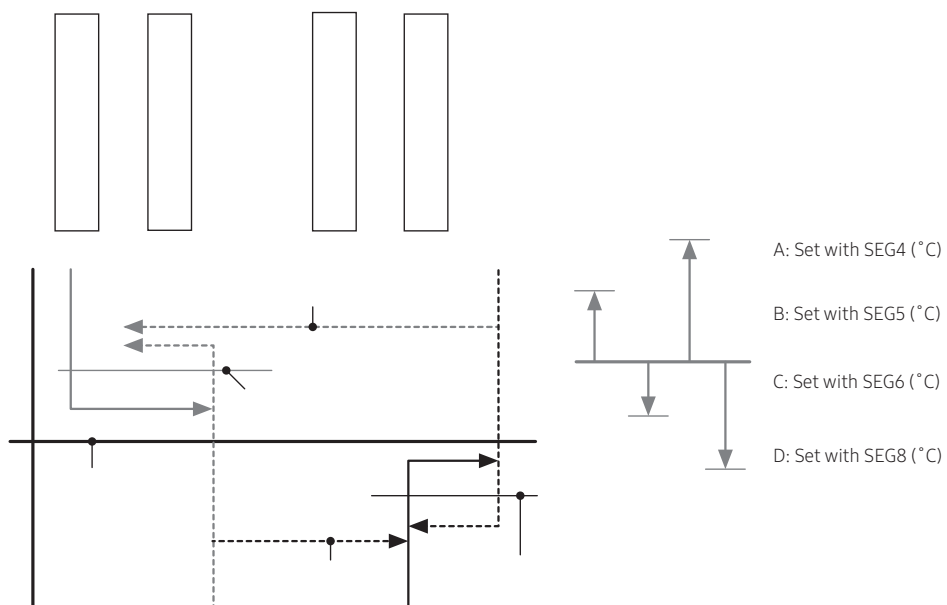



.



[illegible]

Service Department

